

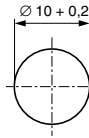

CYLINDRICAL LIGHT INDICATORS

COMPOSED OF A BASIC UNIT AND LENS REMOVABLE OR FIXED



Hole
 $\varnothing 10 \text{ mm} \pm 0,20 \text{ mm}$
 Panel thickness
 0,5/2,5 mm

PANEL HOLE 10 MM DIA. - THREADED UNITS

TB/010/SC
 NI10XRLXXXX

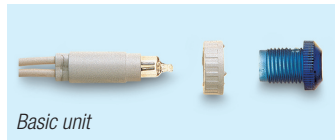
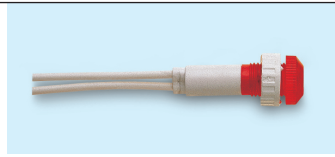
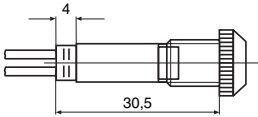

TBF/010/SC
 NI10XRTXXXX

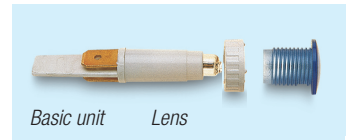
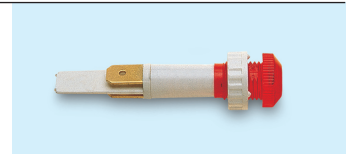
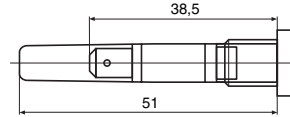

Working voltage - VAC	\oplus Incandescence: 6/12/24 V	\oplus Neon and fluorescence: 110/250/400 V
	In polycarbonate	
Body	In polycarbonate	
Wire ends	TB/010/SC NI10XRLXXXX	PVC sheath wire cross, section 0,50 mm ² , wires length 220 mm, length of stripped wires end 6 mm and 4,8x0,8 mm
	TBF/010/SC NI10XRTXXXX	male faston 6,3x0,8 mm - 4,8x0,8 mm
Lens colour	Incandescence: red, orange, transparent, yellow-green (light green), green, blue	Neon: red, orange, transparent, yellow-green (light green) Fluorescent: green
Variants	Cables: length to customer's requirements - with clamped connectors - silicone insulated - tinned ends Removable lens Anti-luminescence resistor	

FRONT LENS MADE OF POLYCARBONATE

<p>SC 1 = STANDARD</p>	<p>SC 2</p>	<p>SC 3</p>	<p>SC 4</p>	<p>SC 5</p>	<p>SC 6</p>	<p>SC 7</p>
<p>SC 8</p>	<p>SC 9</p>	<p>SC 10</p>	<p>SC 11</p>	<p>SC 12</p>	<p>SC 13</p>	<p>SC 14</p>