

PHONO PLUGS

• Mates with .125 (3.2) diameter jacks

STRAIN RELIEF LUG CRIMPS TO WIRE INSULATION

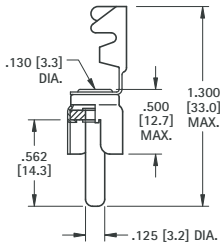

CAT. NO. 565

MATERIAL:
Shell: Steel, Tin Plate
Pin: Brass, Nickel Plate

CONVENTIONAL TYPE

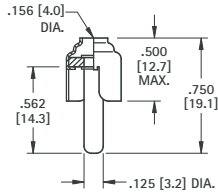

CAT. NO. 561

MATERIAL:
Shell: Brass, Nickel Plate
Pin: Brass, Nickel Plate

CRIMP OR SOLDER TYPE EXTRA LONG HANDLE

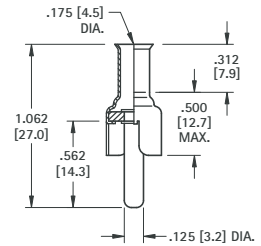

CAT. NO. 567

MATERIAL:
Shell: Steel, Tin Plate
Pin: Brass, Nickel Plate

"F" FEMALE CONNECTOR

SNAP-FIT PC MOUNT

- Low profile
- Snap-fit mounting for positive retention during wave soldering
- Rugged, stable construction facilitates reliable mating
- High reliability, manufactured using Nickel Plated Brass bodies and Tin Plated Phosphor Bronze contacts
- Supplied with washer and nut

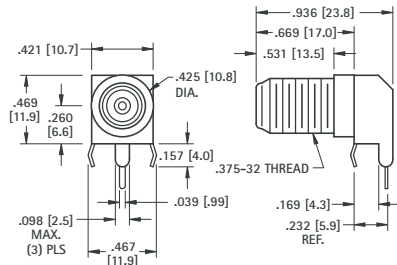

Mounting Detail

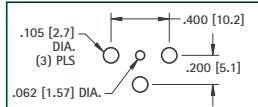

CAT. NO. 911

PANEL MOUNT PHONO JACKS

- Mates with .125 (3.12) dia. pin
- Mounts to panel in .296 (7.6) dia. hole
- Color coded for ease of identification
- Complete with nut and solder lug

ROUND BASE

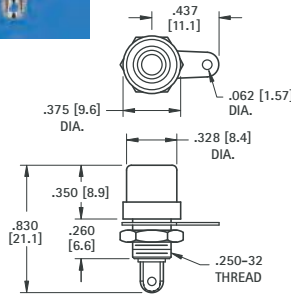

CAT. NO.	INSULATOR COLOR
598	WHITE
580	RED
574	BLACK
599	YELLOW

HEX BASE

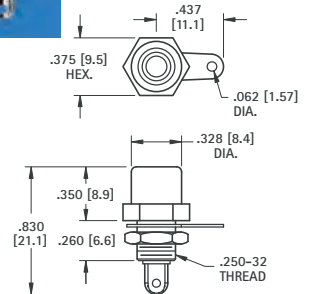

CAT. NO.	INSULATOR COLOR
581	WHITE
582	RED
576	BLACK
583	YELLOW

MATERIAL:
 Brass, Nickel Plate

COLOR KEYED - PC PHONO JACKS

- Mates with .125 (3.2) diameter pins
- Features a normally closed circuit
- Various colors for circuit identification
- Snap-fit mounting for positive retention during wave soldering

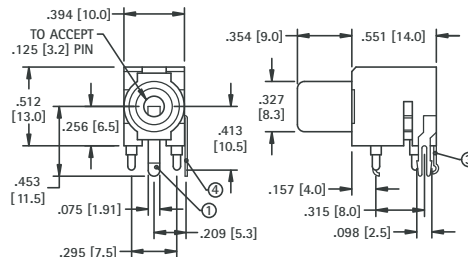

CAT. NO.	INSULATOR COLOR
970	WHITE
971	RED
972	BLACK
973	YELLOW

SPECIFICATIONS

Housing: PBT
Ground Terminal: .020 (.51) Brass, Nickel Plate ①
Spring Contact: .012 (.30) Phosphor Bronze, Silver Plate ③
Shunt Terminal: .016 (.41) thick Brass, Silver Plate ④

SCHEMATIC



Mounting Detail

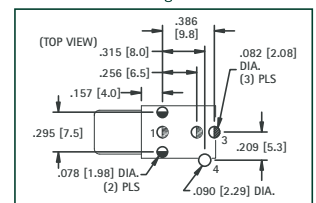

90° PC PHONO JACK



Complete one piece jack for insertion into PC board.
Time Saving. No Wiring Required.

- Black insulator ring.

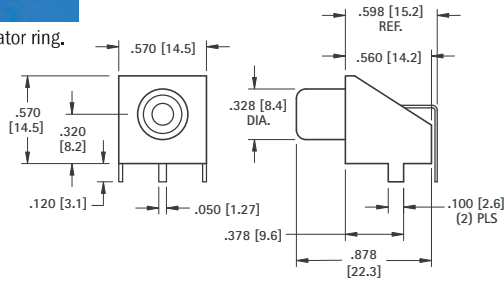

Mounting Detail

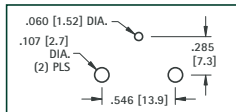

MATERIAL:

Base: Steel, Tin Plate
Shell: Steel, Nickel Plate
Contact: Brass, Tin Plate

CAT. NO. 902

SNAP-FIT 90° PC PHONO JACKS



CHOICE OF TIN OR GOLD PLATE

Complete one piece jack for insertion into PC board.
Time Saving. No Wiring Required.
Snap-fits into PC board.

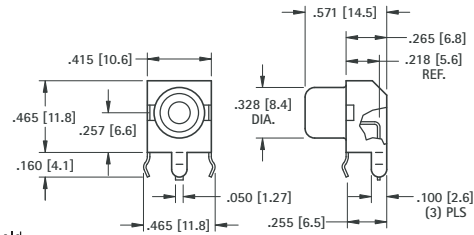

MATERIAL:

Shell: Steel
Contact: Brass
Plating: Tin or Gold

TIN PLATE CAT. NO.	INSULATOR COLOR	GOLD PLATE CAT. NO.
587	WHITE	936
588	RED	937
901	BLACK	900
589	YELLOW	938

Mounting Detail

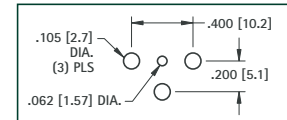

SNAP-FIT VERTICAL PC PHONO JACK

- Snaps into holes on PC board and firmly held for soldering
- No staking required



- Red insulator ring

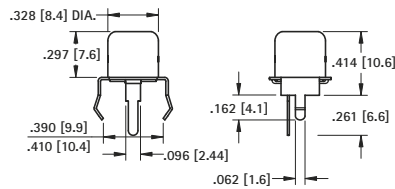

Mounting Detail

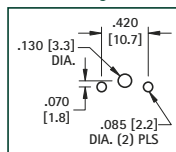

MATERIAL:

Shell: Steel, Tin Plate
Contact: Brass, Tin Plate

CAT. NO. 572

SNAP-FIT VERTICAL PC PHONO JACKS

- Extra long, one piece shell to accept plugs with longer pins for greater contact
- Snaps into holes on PC board and firmly held for soldering
- No staking required

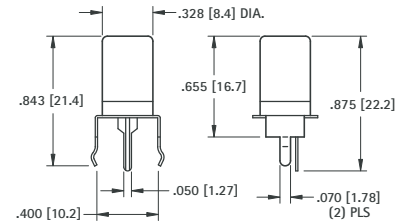

Mounting Detail

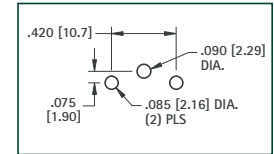

CAT. NO.	INSULATOR COLOR
584	WHITE
577	RED
585	BLACK
586	YELLOW

MATERIAL:

Shell: Steel, Nickel Plate
Contact: Brass, Tin Plate

PC PHONO JACKS

VERTICAL

- For applications requiring staking to product



- White insulator ring

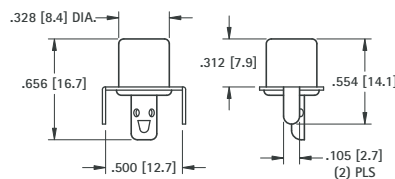

Mounting Detail

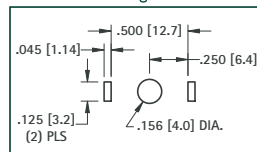

MATERIAL:

Shell: Steel, Tin Plate
Contact: Brass, Tin Plate

CAT. NO. 573

HORIZONTAL

- Mounted on bracket ready for insertion into pre-drilled holes
- Solder lug allows remote attachment of signal to PC board



- Red insulator ring

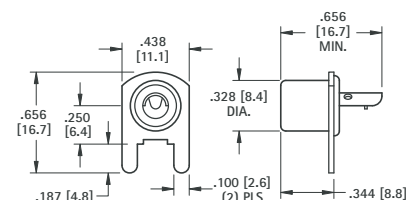

Mounting Detail

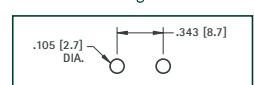

MATERIAL:

Shell: Steel, Tin Plate
Contact: Brass, Tin Plate

CAT. NO. 571